



FAG

6014-2Z

Deep groove ball bearing

Schaeffler ID:
0167180460000Deep groove ball bearing 60...-2Z, single
row, shields, steel sheet metal cage

Technical information

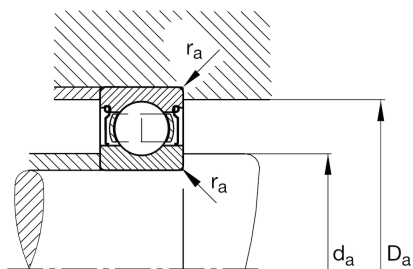
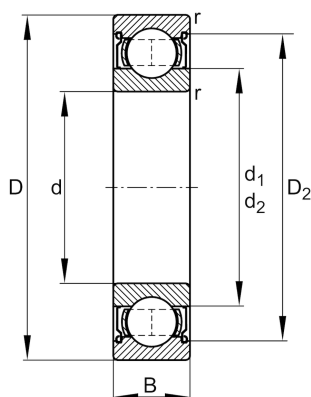
**Main Dimensions & Performance Data**

| | | |
|----------|-------------|-----------------------------------|
| d | 70 mm | Bore diameter |
| D | 110 mm | Outside diameter |
| B | 20 mm | Width |
| C_r | 40.500 N | Basic dynamic load rating, radial |
| C_{0r} | 31.000 N | Basic static load rating, radial |
| C_{ur} | 1.900 N | Fatigue load limit, radial |
| n_G | 7.300 1/min | Limiting speed |
| n_{gr} | 6.800 1/min | Reference speed |
| | 0,596 kg | Weight |

Dimensions

| | | |
|-----------|---------|------------------------------|
| r_{min} | 1,1 mm | Minimum chamfer dimension |
| D_2 | 100 mm | Caliber diameter outer ring |
| d_1 | 82,8 mm | Shoulder diameter inner ring |

Mounting dimensions

| | | |
|-------------|--------|--------------------------------------|
| $d_{a min}$ | 76 mm | Minimum diameter shaft shoulder |
| $D_{a max}$ | 104 mm | Maximum diameter of housing shoulder |
| $r_{a max}$ | 1 mm | Maximum fillet radius |

Calculation factors

| | | |
|-------|------|--------------------|
| f_0 | 15,6 | Calculation factor |
|-------|------|--------------------|

Temperature range

| | | |
|-----------|--------|----------------------------|
| T_{min} | -20 °C | Operating temperature min. |
| T_{max} | 120 °C | Operating temperature max. |